

# AT1 ASSET GPS TRACKER INSTRUCTIONS

**ALWAYS FULLY CHARGE YOUR DEVICE BEFORE FIRST USE.**

**GPSX.UK**

## Basic operation

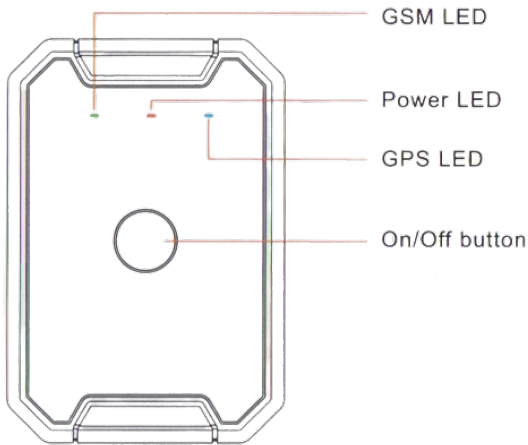

**Power ON** - Press and hold the ON/OFF button for 3 seconds. The LED lights will start flashing if powered up successfully.

**Power OFF** - Press and hold the ON/OFF button for 3 seconds and the LED lights will extinguish after a few seconds.

*You can check if the device is switched on by pressing the ON/OFF button for one second and if any lights illuminate, the device is switched on.*

## Your device supports two tracking modes:

**ONLINE MODE** - device will upload regular updates to the GPSX server so you can track the device in near realtime. Works like a regular vehicle tracking device. (The battery will typically last around 2 - 3 weeks based on 2 hours active tracking per day, before it needs to be recharged.)

**SLEEP MODE** - device sends a single update then enters a sleep state for a specified period (1,3,6,12 OR 24 hours) (The battery could last upto 1.5 years based on a sleep interval of 24 hours)

## Setting the tracking mode from the mobile app

1. From the menu page, select 'Object Control'

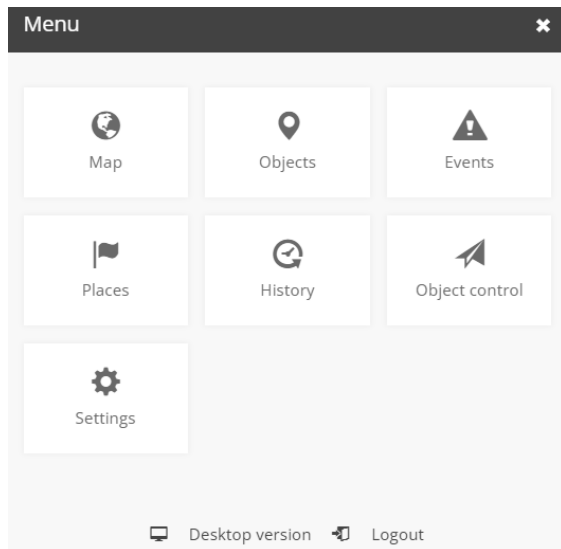

2. Select the required mode then click the 'Send' button

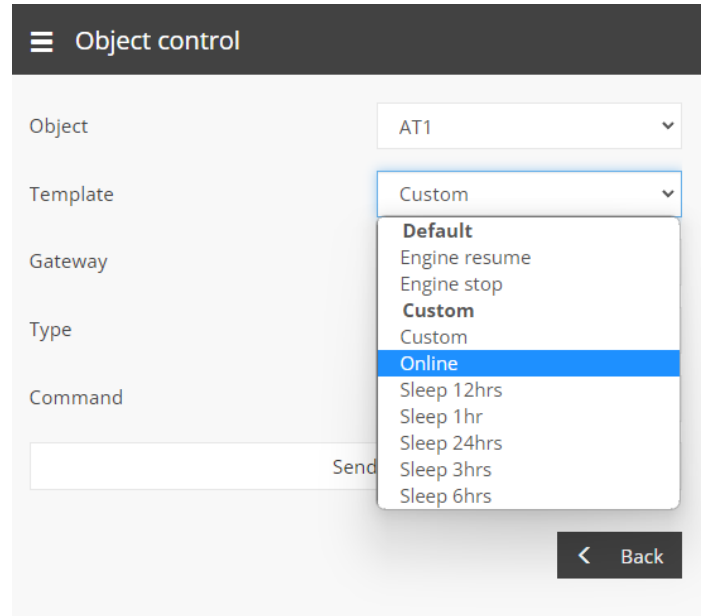

**Download the mobile APP at [gpsx.uk](https://gpsx.uk)**

**Login at our website [login.gpsx.uk](https://login.gpsx.uk) or on the mobile APP**

**Username and password are printed on the device box or package**

**Need assistance? Email us at [support@gpsx.uk](mailto:support@gpsx.uk)**